



PG-30 Digital Pressure Gauge User Manual



Low Pressure Gauge

High Pressure Gauge

Important

Thank you for buying our brand new pressure gauge. Please read this manual thoroughly before use and keep the manual with the gauge for further consultation.

Overview

PG-30 digital pressure gauge is a professional instrument for pressure monitoring in refrigerating system and related refrigerant parameters. The gauge features backlight, auto off, measurement units switch, alarm and other functions.

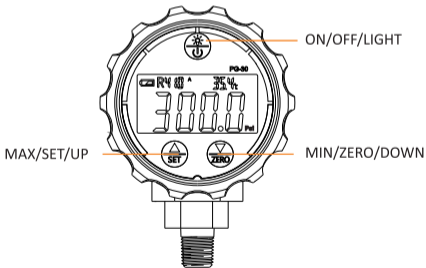

Operation

1. ON/OFF

ON: Press  button and it will display current pressure.

OFF: Press and hold  button until the screen is off.

2. Backlight

When the gauge is ON, press  button to light up backlight.

The backlight will be auto off after 6 seconds of inactivity.

3. Max and Min Memory and Clear

Press  button to display Max value and MAX symbol, then press the same button again for 3 seconds to clear the current Max value.

Press  button to display Min value and MIN symbol, then press the same button again for 3 seconds to clear the current Min value.

4. Zero

Press and hold  for 3 seconds until 8.8.8.8 shows on the screen, then release it to clear the current value to 0.

Note: Please zero the gauge before connecting it to the system.



5. Auto OFF





Enable Auto Off: Press and hold  and  until ON shows. If pressure keeps unchanged for 15 minutes, the gauge will be off automatically.

Disable Auto Off: Press and hold these two buttons until OFF shows.

6. Refrigerant Selection; Temperature/Pressure Units Switch

◆ Refrigerant Selection: Press and hold  button for 3 seconds until "R" shows and flashes, then press  or  button to switch between refrigerants.

◆ Switch Temperature Unit: Press and hold  button for 3 seconds until "R" shows and flashes, then press  button to switch between °C and °F.

◆ Switch Pressure Unit: Press and hold  button for 3 seconds until "R" shows and flashes, then press  button twice to switch between pressure units. Then use  or  button to select your desired pressure unit. Press  button again to exit setting status.

Note: The gauge will exit setting status after 15 seconds of inactivity.

Specifications

Pressure Range:

Low Pressure Gauge: -14.5~500psi (-0.1~3.4MPa)

High Pressure Gauge: -14.5~800psi (-0.1~5.5MPa)

Resolution: 0.5psi

Accuracy: $\pm 0.5\%$ FS

Measurement Units: MPa, kPa, bar, psi, kg/cm², cmHg

Temperature Unit: °C / °F

Compatible Refrigerants: 91

Over Range Alarm: Displays -OL-

Battery Life: 6 months

Operating Temperature: -10°C~60°C

Power Supply: CR2450

Sampling Rate: 1 seconds

Low Battery Indication: Displays "  "

Compatible Refrigerants

R11	R14	R401A	R407E	R416A	R441A	R503
R113	R141B	R401B	R407F	R417A	R442A	R504
R114	R142B	R401C	R408A	R419A	R443A	R507A
R115	R143A	R402A	R409A	R420A	R444A	R508A
R116	R152A	R402B	R409B	R421A	R448A	R508B
R12	R161	R403A	R41	R421B	R449A	R509A
R123	R170	R403B	R410A	R422A	R449B	R513A
R1234yf	R21	R404A	R410B	R422B	R450A	R600
R1234ze	R218	R406A	R412A	R422C	R452A	R600a
R124	R22	R407A	R413A	R422D	R455A	R601
R125	R23	R407B	R414A	R423A	R50	R601a
R13	R290	R407C	R414B	R427A	R500	R740
R134a	R32	R407D	R415B	R437A	R502	R744

Battery Replacement

1. Please take off the rubber boot, loosen the two screws and remove rear case.

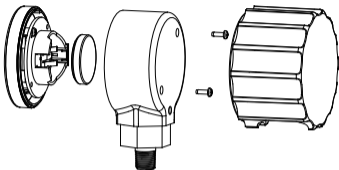

2. Use a flat screwdriver to take out the battery in the same direction as shown below:

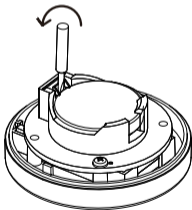

3. Place a new battery into the compartment and assemble the gauge. Please note the screws must be tightened.

